

APPLICANT SCORE SHEET: LOUISVILLE METRO EMS PHYSICAL AGILITY TEST

<i>Candidate Name:</i>			<i>Date:</i>	
No.	Event	Tasks	Notes	X = FAIL ✓ = PASS
	Car Entry	Climb through open window of car – exit vehicle by opening door. <i>Untimed event, not part of course</i>		
1	Ambulance Exit	Unbuckle, open door, exit front of cab, walk to rear of ambulance <i>Time starts when door is opened</i>		
2	Stretcher Unload	Open doors to patient compartment, lift stretcher, walk backwards with stretcher		
3	Equipment Unload	Gather and carry cardiac monitor and medical bag from stretcher.		
4	Equipment Carry	Carry cardiac monitor and medical bag and turn corner towards stairwell.		
5	Stair Climb (with Medical Equipment)	Carry cardiac monitor and medical kit up a flight of stairs, down, up, down and up again. Set equipment in designated area at top of stairs.		
6	Chest Compressions	Complete 2 minutes of Chest Compressions (100 per min)		
7	Equipment Retrieval	Bend and pick up cardiac monitor and medical bag. Descend stairs, ascend and descend stairs again with equipment.		
8	Loaded Stair Chair Push	Set down equipment in designated area. Push loaded stair chair along marked path and serpentine through the cones and back to original location.		
9	Equipment Retrieval	Gather and carry cardiac monitor and medical bag to stretcher at the back of the ambulance.		
10	Stretcher Load (with Patient)	Lift and push loaded stretcher into patient compartment of ambulance (assistance provided only to lift wheels)		
11	Rear Truck Entry	Step up into patient compartment and sit on bench seat. <i>Time stops when candidate sits on bench seat</i>		
END		TOTAL TIME (MUST BE 6 MIN 50 SEC OR LESS TO PASS)	Circle One:	PASS FAIL
<i>Evaluator Name and Signature:</i>			<i>Candidate Signature:</i>	

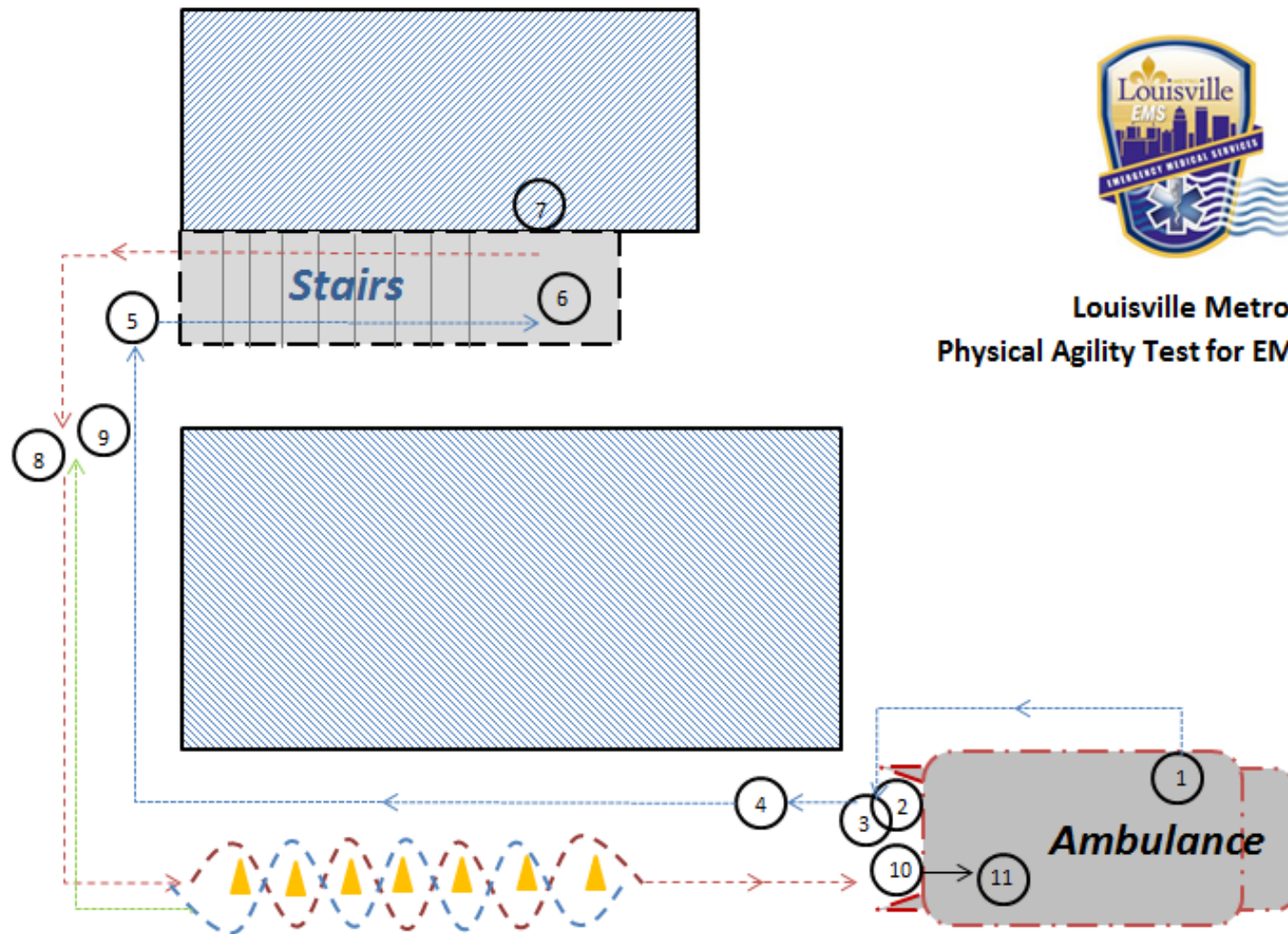

Louisville Metro EMS
Physical Agility Test for EMTs/Paramedics



- | | |
|---|-----------------------------------|
| 1. Vehicle Exit | 7. Equipment Retrieval |
| 2. Stretcher Unload | 8. Loaded Stair Chair Push |
| 3. Equipment Unload | 9. Equipment Retrieval |
| 4. Equipment Carry | 10. Stretcher Load (with Patient) |
| 5. Stair Climb (with Medical Equipment) | 11. Rear Truck Entry |
| 6. Chest Compressions for 2 minutes | |

Legend

- | | |
|---------------------|-----------------------|
| To Scene | — (blue dashed line) |
| To Ambulance | — (red dashed line) |
| Equipment Retrieval | — (green dashed line) |