

# VINE LINK SYSTEM

## HOW TO SEARCH FOR AN INMATE

After you have gone to the **VINE System home page** using the link provided, you will need to follow the below instructions.

1. Click the **Search & Register Tab**.



2. Choose the **Metropolitan Department of Corrections** as the facility if the inmate is being held in Jefferson County.

A screenshot of a form titled "Select the Facility that you would like to search." It contains three radio button options: "All Facilities", "Department of Corrections", and "Choose Facility". The "Choose Facility" option is selected. To the right of this option is a dropdown menu currently displaying "Metropolitan Department of Corrections". A red arrow points to this dropdown menu.

3. Enter the inmates **First** and **Last** name or Offender ID number which is also known as the inmates CIN number.

A screenshot of the search input section. It features a blue header bar with the text "Enter the Offender ID or Offender's First and Last Name." Below this are three input fields: "\*Offender ID:", "\*Last Name:", and "\*First Name:". A red arrow points to the "\*Offender ID:" field. Below the "\*Last Name:" field, there are two red arrows pointing to the right. Below the "\*First Name:" field, there is a note: "Note that the first name can be a partial search, entering 'JO' will match 'JOHN', 'JOE' etc." At the bottom left, there is a small note: "\*Indicates Required Field".

4. Click **SEARCH** Search at the Bottom of the page.

5. Complete the Word Verification by entering the masked characters in the text box you see on your screen and click **CONTINUE**.

**Word Verification**

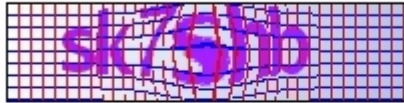

In an effort to prevent unauthorized use of our service, we limit the number of searches performed on our site. To continue, please enter the word you see above into the box below.

6. You will see the below message box. Click the **YES** button to Continue.

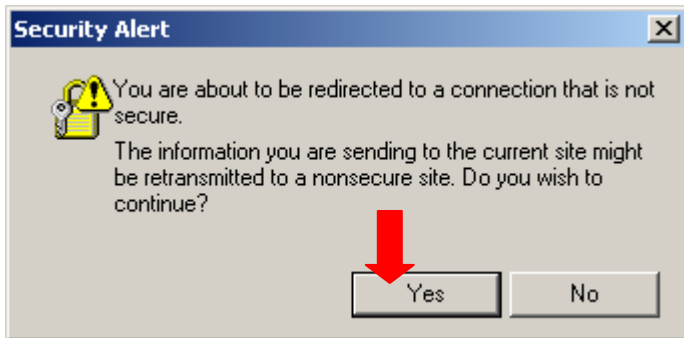

7. You may be able to view the inmates information

Kentucky Statewide VINE  
VINE Service Number : (800) 511-1670

**Search Results**

We found the following 1 offender(s).

*NOTE: Names in italic are alias names.*

Register/ Details	Last Name	First Name	Date of Birth	Age	Custody Status	Facility/Reason	Reporting Agency
----------------------	--------------	------------	---------------	-----	-------------------	-----------------	---------------------

If no information is displayed and the inmate is still in custody, you will be asked to enter the information again. Go back to Step 2 and repeat the instructions.